



**WTC MACHINERY** Engineered to perform. Built to last.

WTC Machinery is a global leader in designing and building machinery and tooling for heavy equipment repair facilities.

## FP100 Portable Pin Press

### Overview

WTC Machinery's FP100 – 100 Ton Portable Pin Press is designed to make field operations easier and safer. This pin press has a light, user-friendly system and is ideally suited to service excavator and bulldozers up to a Caterpillar D9, Komatsu PC600 or D155. It also has the capability to service other makes of excavator and bulldozer or any type of machinery using track style chains like trencher chains or apron feeders. Featuring an open c-frame design and a full range of tooling, the FP100 press can service track style chains with pin diameters ranging from .76" (19 mm) up to 2.56" (65,1 mm).



FP100E

The FP100 press is available without a hydraulic pump, or we provide several durable pumps to match shop or a service truck power. For safety during use, we also offer an optional pressure gauge, lifting sling (engineered specifically for use with this press) and a safety blanket (to protect from possible flying debris).

To protect your investment and keep everything together in one convenient spot WTC offers a custom storage/travel box for safe and secure storage and transportation of your FP100 press, pump and tooling.



FP100-LS3  
Lifting Sling  
with FP100



FP100-LSB Shipping/Travel Box



**W1222 LINDEN ROAD, IXONIA, WISCONSIN 53036 USA**  
**Phone: 800-248-8405 or 262-567-3993 • Fax: 262-567-4307 [www.wtcmachinery.com](http://www.wtcmachinery.com)**

## **MANUFACTURERS/BENEFICIARY'S WARRANTY CERTIFICATE WTC MACHINERY, LLC WARRANTY**

WTC MACHINERY, LLC warrants its products to be free from defects in material and workmanship under normal use and service for a period of twelve (12) months after date of shipment. WTC MACHINERY, LLC undertakes to be responsible for any defect that may arise due to faulty raw materials, design, workmanship and defective parts and to replace them without extra cost. Freight charges are the customer's responsibility. Our warranty is not transferable.

WTC MACHINERY, LLC shall have the option of requiring the return of all parts claimed defective. Parts proved to be defective, due to defect in workmanship and/or material, shall be either repaired or replaced free of charge, F.O.B. our designated factory. All parts warranty claims are subject to inspection by WTC MACHINERY, LLC and acceptance at the factory

Our warranty does not obligate us to bear the cost of labor or transportation charges in connection with the replacement or repair of defective parts and the removal and/or remounting of the parts repaired or replaced under this warranty, unless specifically authorized in writing by WTC MACHINERY, LLC. All parts returned to the factory must be shipped freight prepaid; no collect freight will be accepted by the factory. Forms authorizing such returns for inspection must accompany all returns.

This warranty shall not apply to products not manufactured by WTC MACHINERY, LLC. Outside purchased equipment and accessories (not of WTC manufacture) are warranted only to the extent of the original equipment manufacturer's warranty and subject to their allowance to WTC MACHINERY, LLC. In this respect, our warranty obligations must conform and be limited to the warranty extended to WTC MACHINERY, LLC by its suppliers as extended to the customer.

We shall, in no event, be liable for consequential damages or contingent liability arising out of the failure of any unit or part to operate properly, or that is subject to:

- Ordinary operating wear, abuse, misuse, or overloading;
- Repairs or alterations by parties other than WTC MACHINERY, LLC;
- The use of improper fluids, contaminated fluids or improper filtering;
- The use of improper voltage hookup in the electrical connections of any equipment;
- Negligence, accident or damages due to deterioration during periods of storage by the purchaser prior to installation and operation;
- Damages occurred in shipment after leaving factory en route to customers' delivery point, as title to equipment passes to customer when loaded onboard for shipment, f.o.b. factory, and customer must place his own claim against damaged goods directly to the shipping company and not against WTC MACHINERY, LLC, its factory, or any of its personnel.
- Damages due to circumstances beyond the control of WTC MACHINERY, LLC and in connection with fulfilling any obligation under this warranty.

To the maximum extent permitted by applicable law, in no event shall WTC Machinery, LLC be liable for indirect, special, incidental or consequential damages resulting from personal injury, loss of business profits or business interruption from the use of its products, or from the inability to use its products.

This warranty is exclusive and is in lieu of all other expressed and implied warranties, including but not limited to implied warranties or merchantability and fitness for a particular purpose. WTC MACHINERY, LLC shall not be subject to any other obligations or liabilities whatsoever with respect to equipment manufactured or supplied by WTC MACHINERY, LLC, or services rendered to it.



**PART IDENTIFICATION**

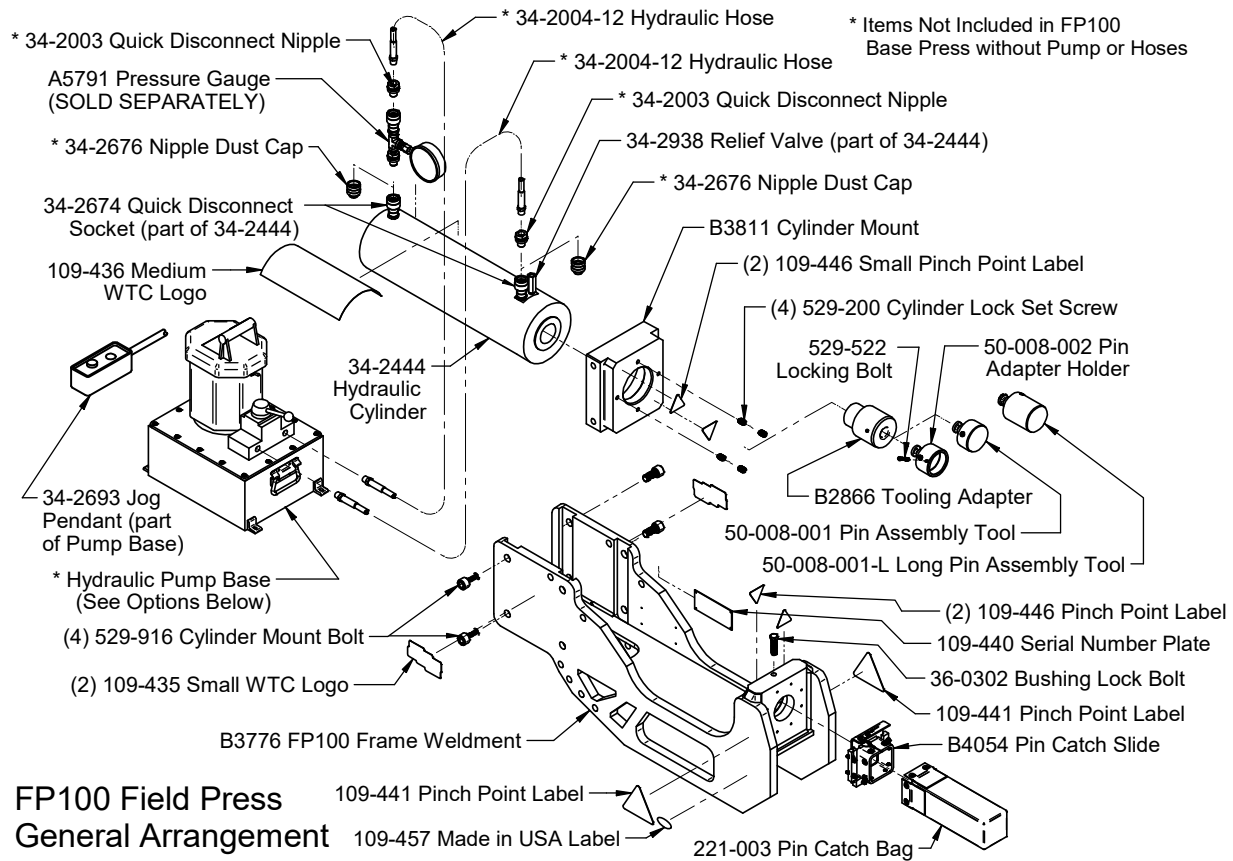

**MODEL LISTING**

- FP100\*\*\*** FP100 with Cylinder, less Hydraulic Parts (Pump, Hoses and Fittings)  
– Customer-supplied Pump Base and Hydraulic Hoses
- FP100H\*\*\*** FP100 with Hand Pump  
– Includes 34-2999 Hand Pump
- FP100E** FP100 with 115 V Electric Powered Pump  
– Includes 34-3094 Electric Pump 115V 60 Hz
- FP100-220** FP100 with 220V 60Hz Electric Powered Pump (Inside North America)  
– Includes 34-3058 Electric Pump 220V 60 Hz
- FP100-220-50** FP100 with 220V 50Hz Powered Electric Pump (Outside North America)  
– Includes 34-3058 Electric Pump 220V 50 Hz
- FP100-220-CE\*\*\*** FP100 with CE-Certified 220V 50Hz Powered Electric Pump (European Union)  
– Includes 34-2678 Electric Pump 220V 50 Hz CE-Marked
- FP100A** FP100 with Compressed Air Powered Pump  
– Includes 34-3002MPP Air-Powered Pump

\*\*\* **Certified** 

# SECTION 6 –Tooling

**! WARNING!**  
*Only trained personnel familiar with operation should use the FP100.  
 Always make sure the FP100 tools are in good condition and aligned and centered with track components before pressing.  
 Always wear eye protection when operating the FP100.*

**! CAUTION!**  
*Track condition affects the disassembly force, and some track models may exceed the capacity of the FP100.  
 It is the operator's responsibility to determine whether the FP100 is adequate for a particular track.*

The Tool Chart (starting on page 14) show the correct tooling for most crawler track models. For track models not listed, the drawing (below) shows the size ranges for Forcing Pins, Pin Adapters and Backing Bushing. See [www.WTCmachinery.com](http://www.WTCmachinery.com) for updated to tool charts.

FP100LPG	Large Pin Group	1-3, 19-21, 25	1.80" to 2.56" (45,7 to 65,1 mm)
FP100MPG	Medium Pin Group	3-7, 15-18, 24	1.30" to 1.81" (33,0 to 46,0 mm)
FP100SPG	Small Pin Group	7-11, 12-14, 23	0.75" to 1.31" (19,1 to 33,2 mm)
PART NO.	DESCRIPTION	ITEMS INCLUDED	PIN SIZE RANGE

ITEM	PART NO.	INCH	MM	INCH	MM
		MIN PIN DIA.		MAX. PIN DIA.	
1	50-007-001	1.97"	50,0	2.22"	56,3
2	50-007-002	1.72"	43,6	1.97"	50,0
3	50-007-003	1.60"	40,7	1.72"	43,6
4	50-007-010	1.47"	37,3	1.60"	40,7
5	50-007-004	1.34"	34,1	1.47"	37,3
6	50-007-005	1.22"	30,9	1.34"	34,1
7	50-007-006	1.09"	27,7	1.22"	30,9
8	50-007-007	0.94"	23,8	1.09"	27,7
9	50-007-008	0.84"	21,4	0.94"	23,8
10	50-007-009	0.76"	19,3	0.84"	21,4
11	50-007-011	0.63"	15,9	0.76"	19,3

**BASIC PIN GROUPS**

31*	529-522	Pin Locking Bolt
30	See Tool Chart	Pin Assembly Tool
29*	50-008-002	Pin Adapter Holder
28*	50-008-001-L	Long Assembly Tool
27*	50-008-001	Assembly Tool
26*	B2866	Cam-Lock Adapter
ITEM	PART NO.	DESCRIPTION

**ADAPTERS**

\*NOTE: Items 26 - 29 and 31 are included with the FP100

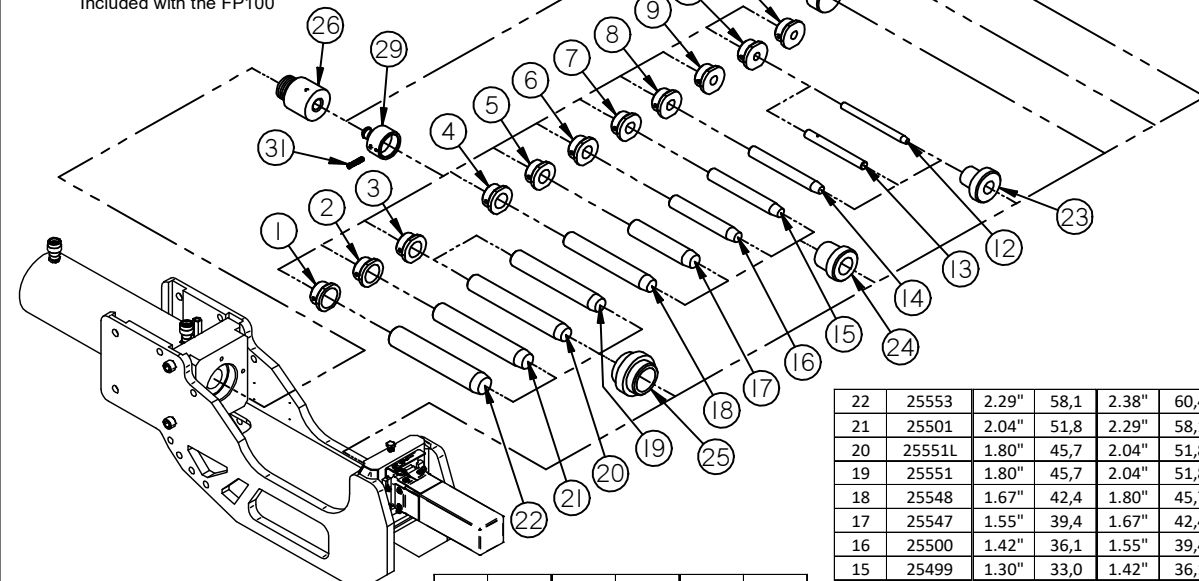

For Disassembly, Pin Adapters hold Forcing Pins  
 For Re-Assembly, Pin Adapters hold Track Pins

25	A3541	1.81"	46,0	2.56"	65,1
24	A3540	1.31"	33,3	1.81"	46,0
23	A3539	0.36"	16,0	1.31"	33,3
ITEM	PART NO.	INCH	MM	INCH	MM
		MIN PIN DIA.		MAX. PIN DIA.	

**BACKING BUSHINGS**

Backing Bushings Support the Track Chain for Disassembly and Re-Assembly

22	25553	2.29"	58,1	2.38"	60,4	1	50-007-001
21	25501	2.04"	51,8	2.29"	58,1	2	50-007-002
20	25551L	1.80"	45,7	2.04"	51,8	3	50-007-003
19	25551	1.80"	45,7	2.04"	51,8	3	50-007-003
18	25548	1.67"	42,4	1.80"	45,7	4	50-007-010
17	25547	1.55"	39,4	1.67"	42,4	5	50-007-004
16	25500	1.42"	36,1	1.55"	39,4	6	50-007-005
15	25499	1.30"	33,0	1.42"	36,1	7	50-007-006
14	25498	1.17"	29,7	1.30"	33,0	8	50-007-007
13	200281	0.90"	22,9	1.17"	29,7	9	50-007-008
12	25503	0.75"	16,0	0.90"	22,9	10	50-007-009
ITEM	PART NO.	INCH	MM	INCH	MM	ITEM	PART NO.
		MIN PIN DIA.		MAX. PIN DIA.		MATCHED PIN ADAPTER	

**FORCING PINS**

For Disassembly, Forcing Pins push the Track Pin  
 For Re-Assembly, Forcing Pins hold the Links Aligned

## FP100 Tooling